



*qsmartonline.com*

# QEye & QShooter Combo

## Installation Guide





---

Model

QES-200

## Installation Diagram

### QEye

- 1 QEye x1 
- 2 QEye Wet Side Magnet x1 
- 3 Mini USB Port x2

(Mini USB Ports can be connected either with power adapter or with QShooter.)



Caution : Risk of Injury from Strong Magnets

### QShooter

- 1 QShooter x1
- 2 Pellet Container x1
- 3 Pellet Tube x1
- 4 Holder x1
- 5 LED Window x1
- 6 Mini USB Port x1

(Connected with QEye by connection Cable)

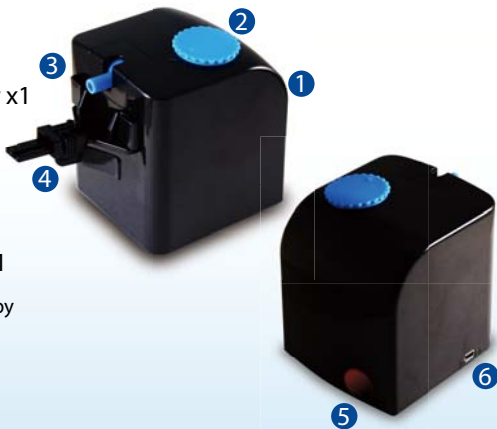

| Item                                | Pictures  | Description  |
|-------------------------------------|---|--|
| QEye                                |    | WiFi Viewing Aquarium<br>(An extra antenna for better signal strength) |
| Wet Side Magnet for QEye            |    | Mount QEye on the Tank<br>(Max. Tank Thickness: 3/4 inch (19 mm))      |
| QShooter                            |    | Auto Feeder to Shoot Pellets<br>(Max. Pellet Size : 2.0 mm)            |
| Holder                              |    | Attach QShooter to The Tank<br>(Max. Tank Thickness: 1 inch (25.4 mm)) |
| Remote Control                      |    | IR Remote Control Feeding  |
| Power Adapter                       |    | Universal Power Supply   |
| Power Adapter Cable 6.5 ft (200 cm) |   | Connect QEye with Power Adapter  |
| Connection Cable 1.64 ft (50 cm)    |  | Connect QEye with QShooter   |

## Installation (1~4)

1. Mount QEye on the aquarium

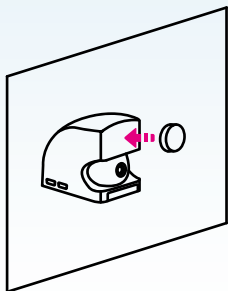

2. Attach the holder to QShooter by sliding

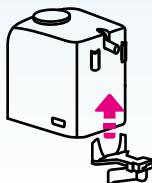

3. Hang QShooter on the tank

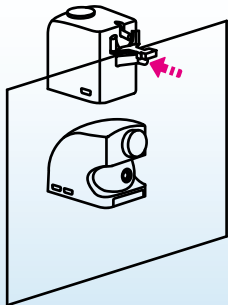

4. Open the lid and pour the pellets

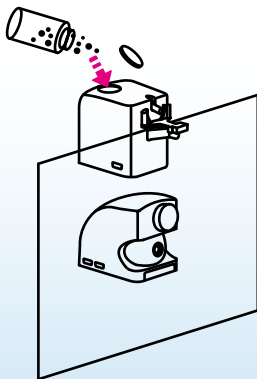

### 5. Please align the dot between QShooter and the lid when closing

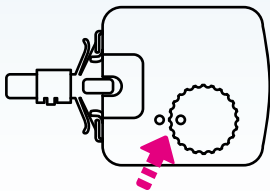

QShooter MUST have the lid firmly sealed to prevent air pressure from escaping (this may cause no shooting).

### 6. Connect QEye with QShooter and connect power

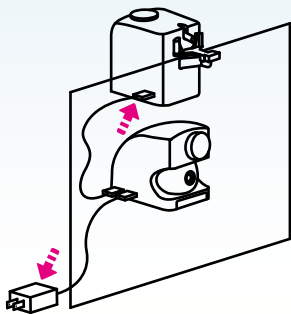

### 7. Download "QSmart" APP

#### QShooter LED Indicator

- LED On : Power On
- LED Flashing Slowly :  
Food Empty
- LED Flashing Quickly :  
Over Shooting (Feeding)



## Installation (8)

### 8. Set up AP Mode

8-1. Tap setting to connect QEYE SSID

(SSID: QEYE \* \* \* \* , Password: 12345678)

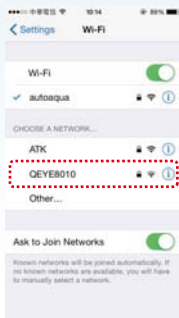

8-2. After connection, go back to QSmart APP and tap "Add QEye"

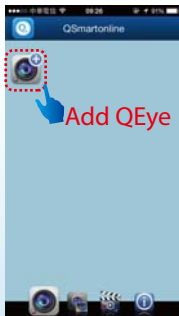

### 8-3. Add QEye (3 Options)

#### I. Key in QEye ID Directly

or

#### II. Scan QR Code

or

#### III. LAN Search

\*Remark

QEye ID & QR Code are on the bottom of QEye.

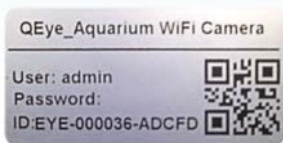

#### I. Key in QEye ID



## Installation (8)

### II. Scan QR Code (Generate QEye ID Automatically)



### III. LAN Search (Recommendation)

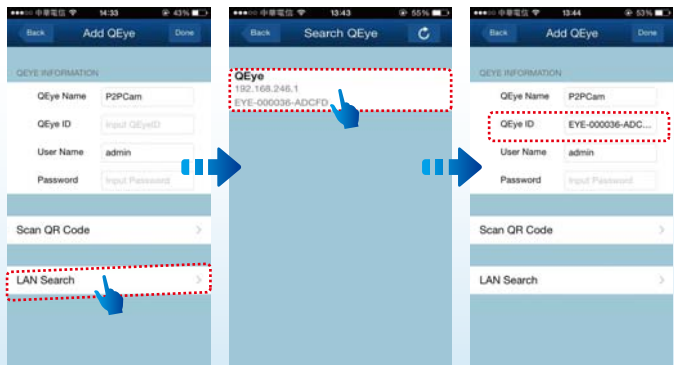



8-4. Use default User Name and password to tap done  
(User : admin, Password: )



## 9. Set up IP Mode from AP Mode

9-1. Tap setting and then go to WiFi setting

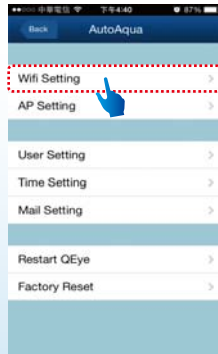
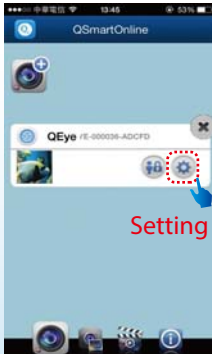

## Installation (9)

9-2. Choose your WiFi Router, key in password and tap join

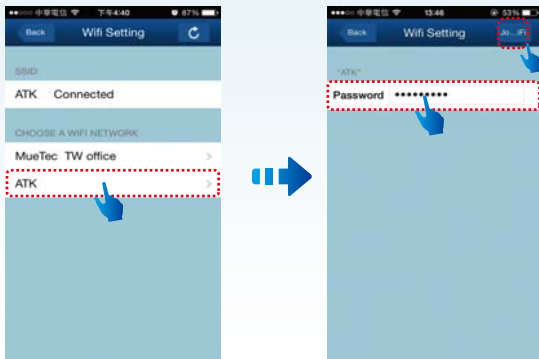

9-3. WiFi setting is done



Shows WiFi setup successfully and will restart  
(Please wait for a few minutes)

9-4. Go back to setting and choose your WiFi again  
(Choosing 3G or 4G / LTE are ok as well)

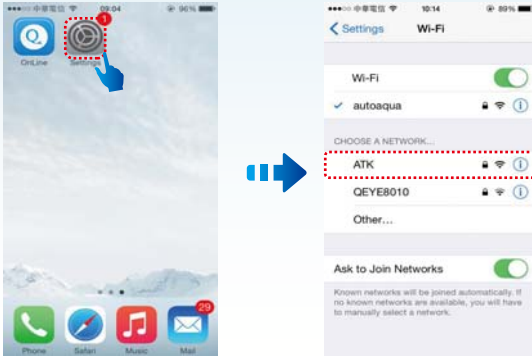

**10. Wait for a few minutes and tap QSmart APP**

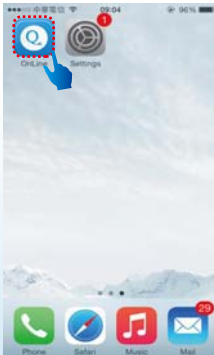

## Installation (11)

### 11. Tap the picture to enjoy viewing & feeding your fish online



#### \*Remark



Blue light : QEye connects successfully.



Red Light : QEye does not connect successfully.



Gray Light : QEye is not online.

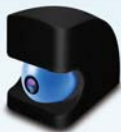

### QEye

1. Power Input : 100-240 VAC 50/60 Hz
2. Power Output (USB) : 5 V 2 A
3. Power Consumption : 5 W (Max.)
4. QEye Size : 2.36 x 2.95 x 3.39 inches/  
60 x 75 x 86 mm  
(Width x Height x Depth)
5. Wet Side Magnet Size : 1.18 x 0.63 inches/  
30 x 16 mm  
(Diameter x Depth)
6. Max. Tank Thickness : 3/4 inch (19 mm)



### QShooter

1. Power Input : 100-240 VAC 50/60 Hz
2. Power Output (USB) : 5 V 2 A
3. Power Consumption : 5 W (Max.)
4. QShooter Size : 3.07 x 3.7 x 3.31 inches/  
78 x 94 x 84 mm  
(Width x Height x Depth)
5. Max. Tank Thickness : 1 inch (25.4 mm)
6. Max. Pellet Size : 2.0 mm

# Remote Control

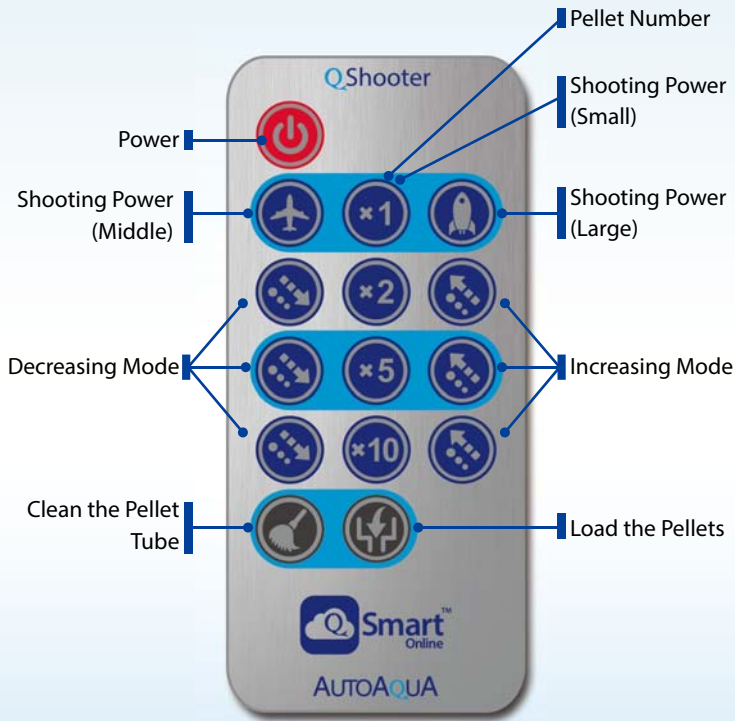

1. Keep QEye & QShooter dry and avoid any contact with water to prevent any malfunction.
2. Strong Magnets might carry the risk of injury. Keep magnets away from objects sensitive to magnets.
3. Please add pellets in mounted QShooter directly without moving QShooter and keep QShooter horizontal.

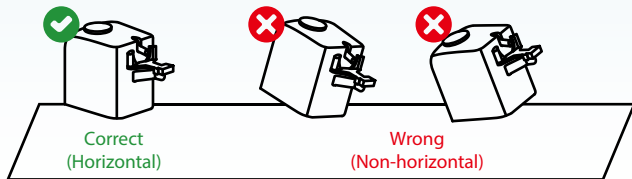

4. Do NOT move QShooter with pellets in it. Please tip pellets out by tipping them from the opposite side of QShooter nozzle as the picture below indicates. Do NOT turn QShooter upside down with pellets in it. Failure to observe these points could cause pellets to move into solenoid valve and block it.

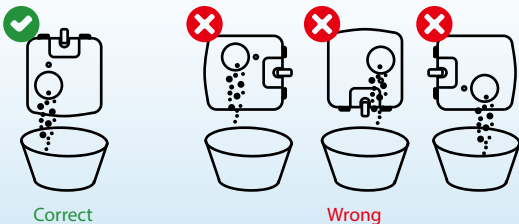



qsmartonline.com

## FCC Statement

This equipment has been tested and found to comply with the limits for a Class B digital device, pursuant to Part 15 of the FCC Rules. These limits are designed to provide reasonable protection against harmful interference in a residential installation. This equipment generates uses and can radiate radio frequency energy and, if not installed and used in accordance with the instructions, may cause harmful interference to radio communications. However, there is no guarantee that interference will not occur in a particular installation. If this equipment does cause harmful interference to radio or television reception, which can be determined by turning the equipment off and on, the user is encouraged to try to correct the interference by one or more of the following measures:

- Reorient or relocate the receiving antenna.
- Increase the separation between the equipment and receiver.
- Connect the equipment into an outlet on a circuit different from that to which the receiver is connected.
- Consult the dealer or an experienced radio/TV technician for help.

This device complies with part 15 of the FCC Rules. Operation is subject to the following two conditions:

- This device may not cause harmful interference
- This device must accept any interference received, including interference that may cause undesired operation.

Changes or modifications not expressly approved by the party responsible for compliance could void the user's authority to operate the equipment.

This equipment complies with FCC radiation exposure limits set forth for an uncontrolled environment. This equipment should be installed and operated with minimum distance 20cm between the radiator & your body.

[More Information  
For Instructions](#)

